

CAMBIO DE VELOCIDADES (1/5)

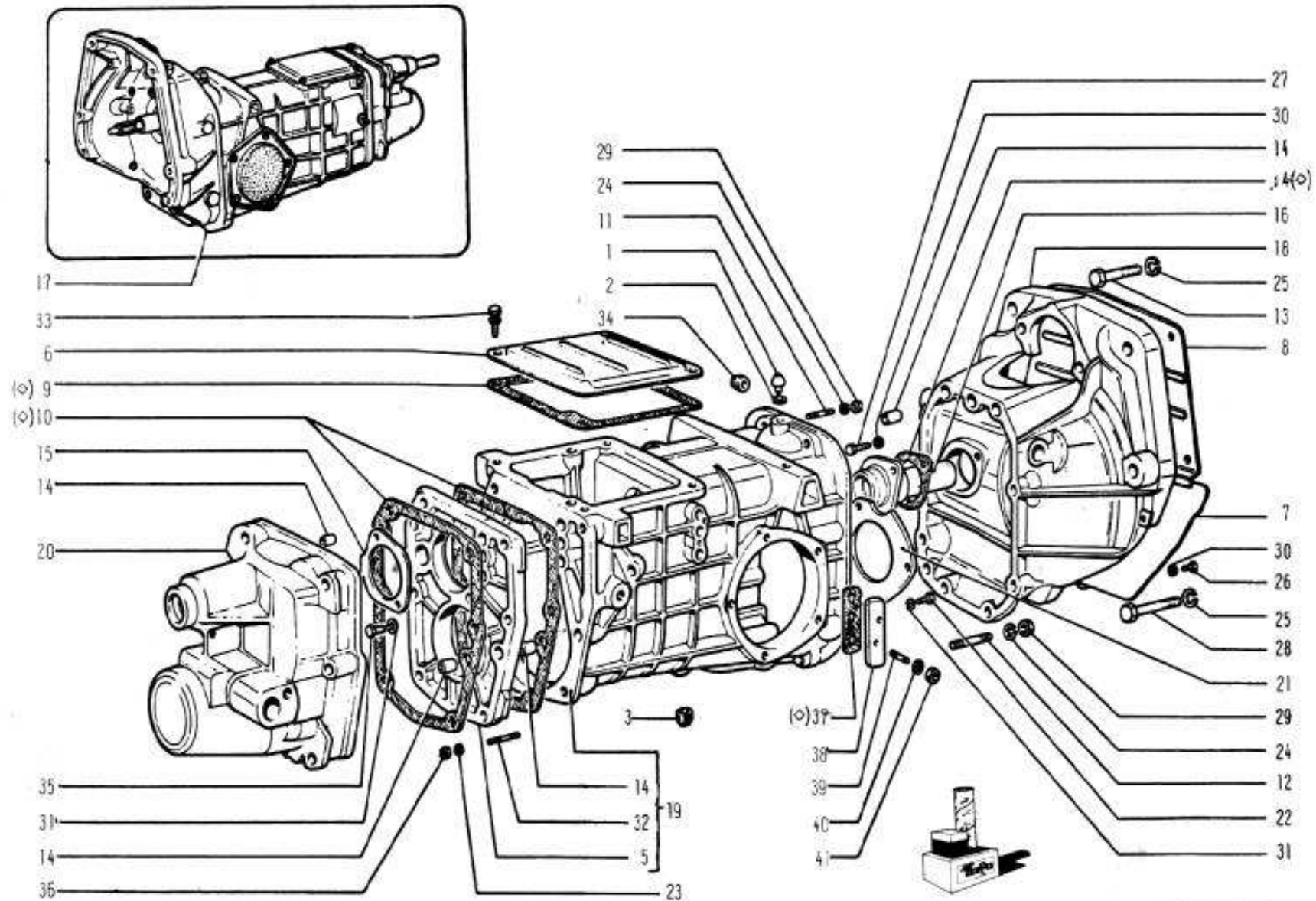

CAMBIO Y DIFERENCIAL. CAJA Y TAPAS

- Cambio e differenziale, scatola e coperchi
- Boîte et différentiel carters et couvercles

- Transmission and Differential Unit, Casign and covers
- Wechsel und Ausgleichgetriebe Gehäuse und Deckel

B2.01

Modelo
800-E

Otobre - 72

CAMBIO DE VELOCIDADES (2/5)

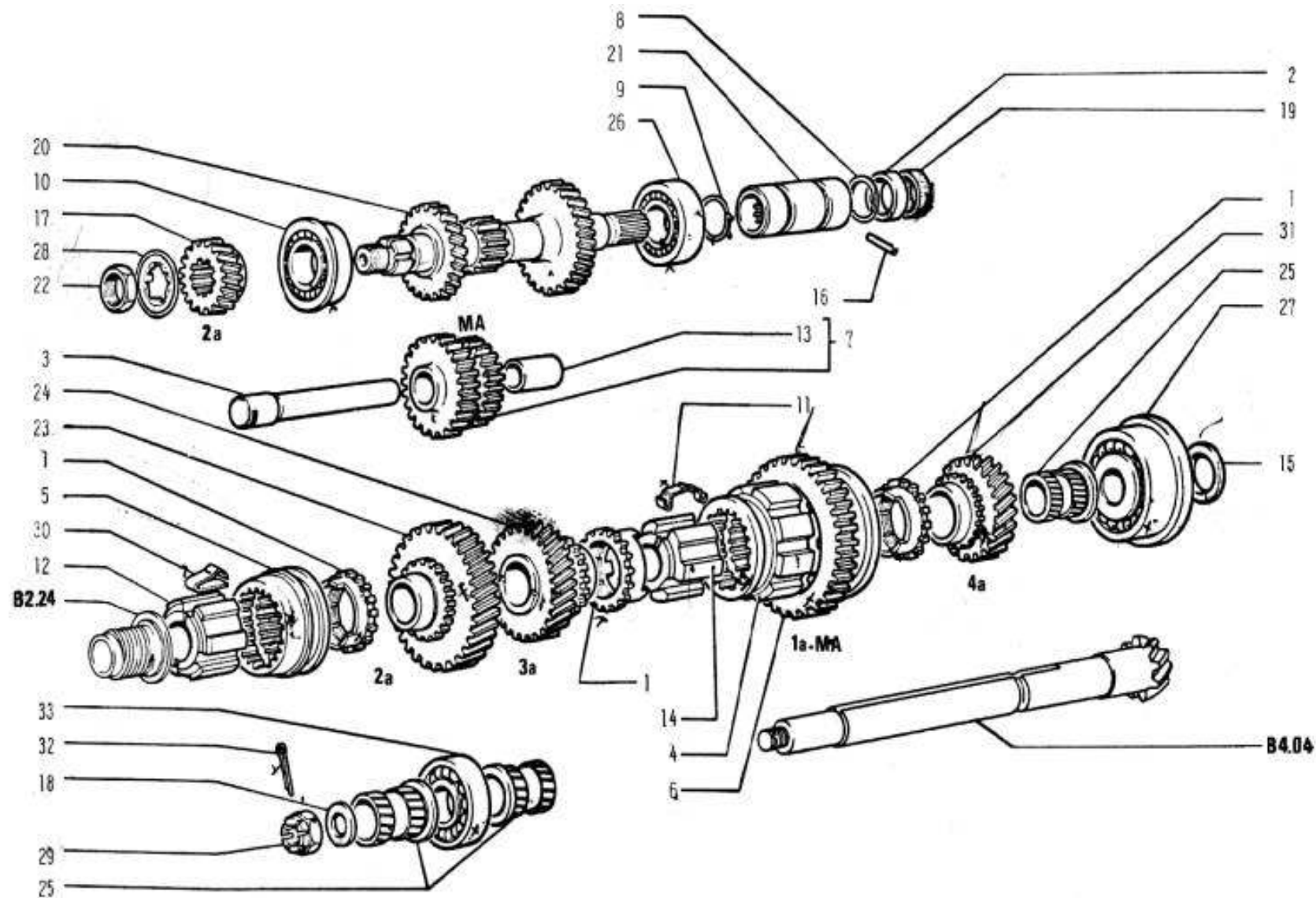

ENGRANAJES DEL CAMBIO

- Ruotismi cambio di velocità
- Engrenages de boîte de vitesses

- Yoke Gears
- Zahnräder und wellen des Wechselgetriebes

B2.04

Modelo
600-E

Dobre - 72

This diagram shows an exploded view of a mechanical assembly. The components are numbered as follows:

- 1: Main housing or base plate.
- 2: A long, thin rod or shaft.
- 3: A small pin or fastener.
- 4: A long, thin rod or shaft.
- 5: A small pin or fastener.
- 6: A small pin or fastener.
- 7: A small pin or fastener.
- 8: A small pin or fastener.
- 9: A small pin or fastener.
- 10: A small pin or fastener.
- 11: A long, thin rod or shaft.
- 12: A small pin or fastener.
- 13: A small pin or fastener.
- 14: A small pin or fastener.
- 15: A small pin or fastener.
- 16: A small pin or fastener.
- 17: A small pin or fastener.
- 18: A small pin or fastener.
- 19: A small pin or fastener.
- 20: A small pin or fastener.

- Comandi esterni cambio di velocità
- Commandes extérieures de boîte de vitesses

- Gearshift Handler
- Äussere Getriebschaltung

**Modelo
600-E**

Octbre - 72

CAMBIO DE VELOCIDADES (4/5)

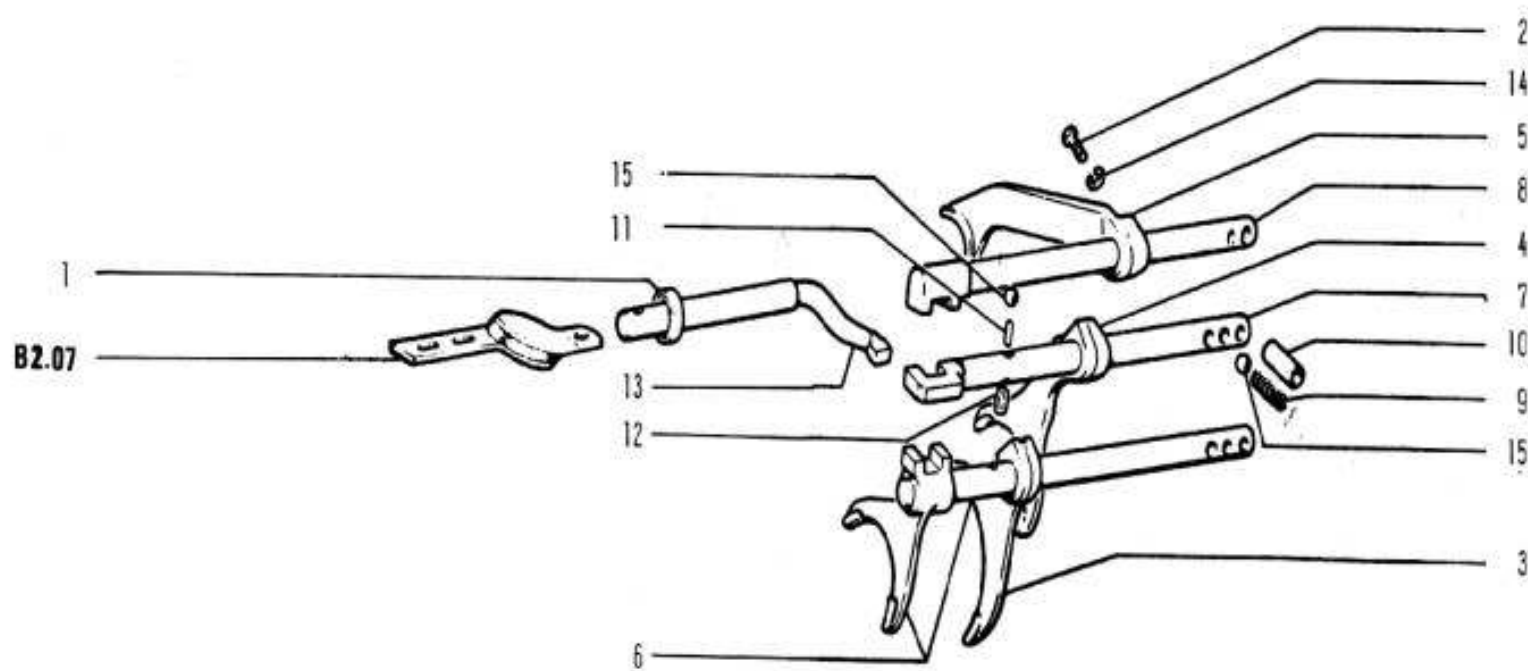

MANDO INTERIOR CAMBIO VELOCIDADES

● Comandi interni cambio di velocita

● Commandes intérieures de boîte de vitesses

● Gearshift Inner Controls

● Innere Getriebeschaltung

B2.10

Modelo
600-E

Octre - 72

CAMBIO DE VELOCIDADES (5/5)

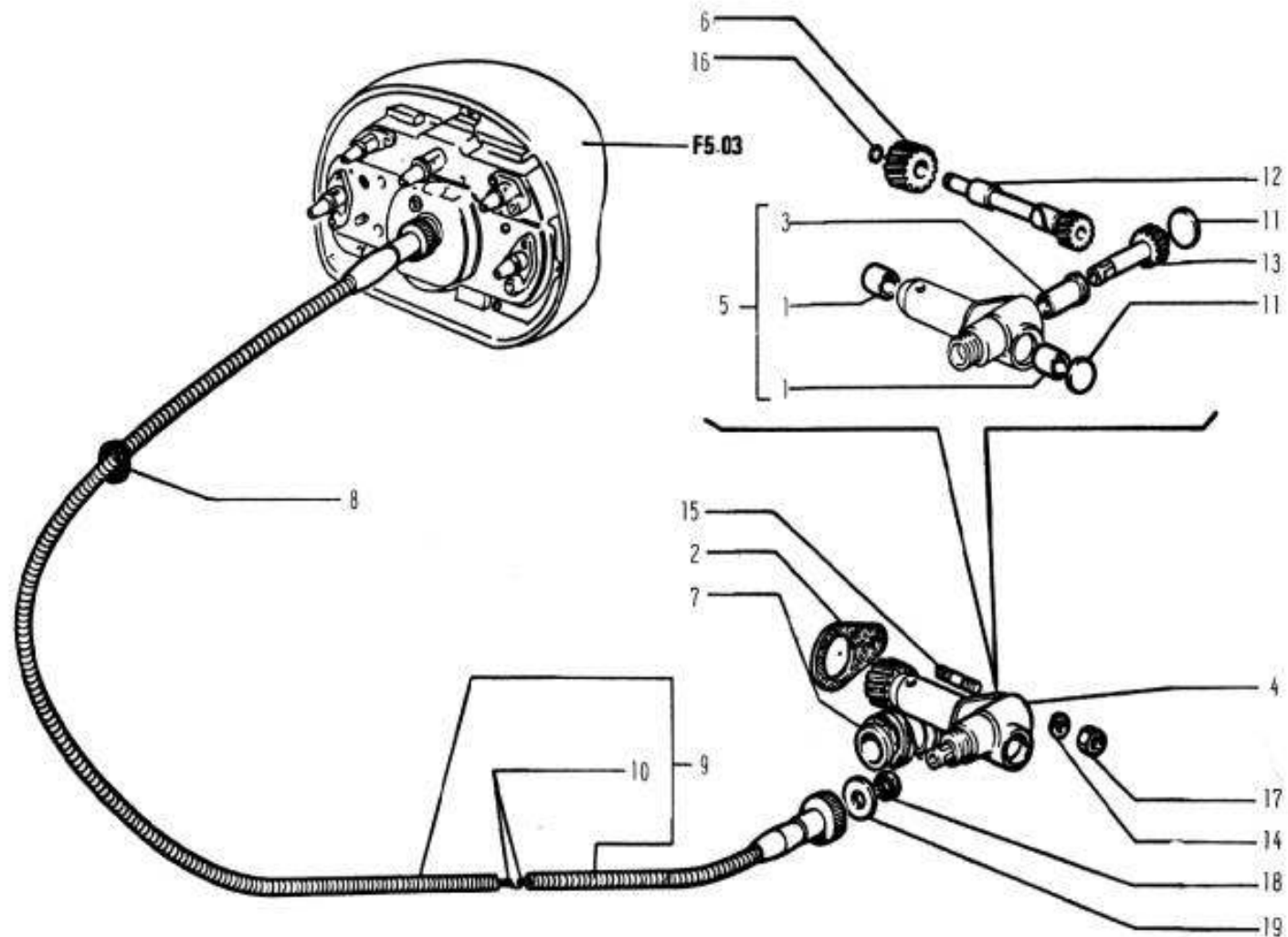

CUENTAQUILOMETROS

- Segnalazione velocità e suo comando
- Compteur de vitesse et sa commande

- Speedometer and Drive
- Tachometer und sein Antrieb

B2.24

Modelo
800-E

Octbre - 72